

Soils Map

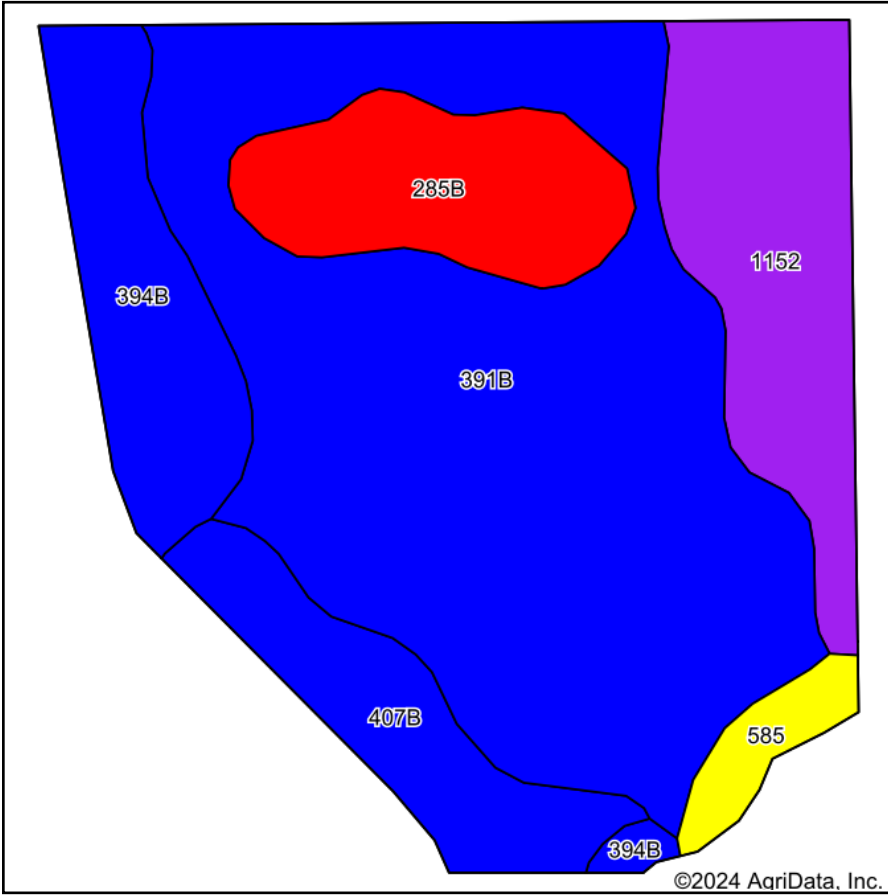

Soils data provided by USDA and NRCS.

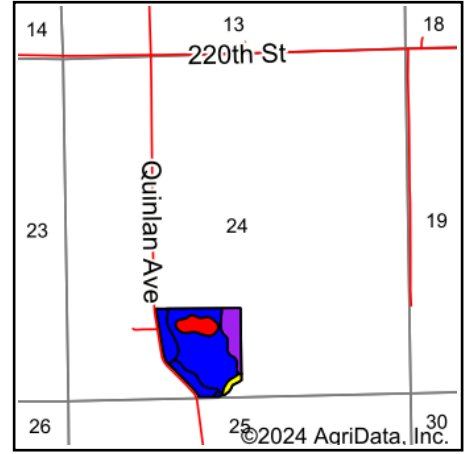

State: **Iowa**
 County: **Chickasaw**
 Location: **24-95N-12W**
 Township: **New Hampton**
 Acres: **33.82**
 Date: **7/8/2024**



Area Symbol: IA037, Soil Area Version: 29

Code	Soil Description	Acres	Percent of field	CSR2 Legend	Non-Irr Class *c	Irr Class *c	CSR2**	CSR
391B	Clyde-Floyd complex, 1 to 4 percent slopes	18.10	53.4%		IIw		87	72
1152	Marshan clay loam, 0 to 2 percent slopes, rarely flooded	4.90	14.5%		IIw		54	67
394B	Ostrander loam, 2 to 5 percent slopes	3.67	10.9%		Ile		88	84
285B	Burkhardt sandy loam, 2 to 5 percent slopes	3.35	9.9%		IIIe	Ile	18	25
407B	Schley loam, 1 to 4 percent slopes	2.97	8.8%		IIw		81	69
585	Coland-Spillville complex, 0 to 2 percent slopes, occasionally flooded	0.83	2.5%		IIw		70	85
Weighted Average							74.5	68

**IA has updated the CSR values for each county to CSR2.

*c: Using Capabilities Class Dominant Condition Aggregation Method

*- Irr Class weighted average cannot be calculated on the current soils data due to missing data.